

RESOLUTION NO. R-2018- 1476

RESOLUTION APPROVING ZONING APPLICATION ABN/CA-2017-01812
(CONTROL NO. 2003-00093)
a Class A Conditional Use
WORKFORCE HOUSING DENSITY BONUS
APPLICATION OF Sunco TH LLC
BY WGINC, AGENT
(Aviera Green)

WHEREAS, the Board of County Commissioners, as the governing body of Palm Beach County, Florida, pursuant to the authority vested in Chapter 163 and Chapter 125, Florida Statutes, is authorized and empowered to consider applications relating to zoning;

WHEREAS, the notice and public hearing requirements pursuant to Article 2 (Application Processes and Procedures) of the Palm Beach County Unified Land Development Code, Ordinance 2003-067 as amended (ULDC), have been satisfied;

WHEREAS, Zoning Application ABN/CA-2017-01812 was presented to the Board of County Commissioners at a public hearing conducted on September 24, 2018;

WHEREAS, the Board of County Commissioners has considered the evidence and testimony presented by the Applicant and other interested parties, the recommendations of the various County Review Agencies, and the recommendation of the Zoning Commission;

WHEREAS, the Board of County Commissioners pursuant to Article 2 (Application Processes and Procedures) of the ULDC is authorized and empowered to consider, approve, approve with conditions or deny the request;

WHEREAS, the Board of County Commissioners hereby incorporates by reference the Findings in the staff report addressing the Standards contained in Article 2.B (Public Hearing Processes) for a Class A Conditional Use;

WHEREAS, this approval is subject to Article 2.E (Monitoring), of the ULDC and other provisions requiring that development commence in a timely manner;

WHEREAS, the issuance of this Development Permit does not in any way create any rights on the part of the Applicant and/or Property Owner to obtain a permit from a state or federal agency and does not create any liability on the part of the County for issuance of the permit if the Applicant fails to obtain requisite approvals or fulfill the obligations imposed by a state or federal agency or undertakes actions that result in a violation of state or federal law;

WHEREAS, the Palm Beach County Survey Section may administratively correct any scrivener's errors that will not significantly impact the overall boundary of the adopted legal description; and,

WHEREAS, Article 2.B.6.C (Board Action) of the ULDC requires that the action of the Board of County Commissioners be adopted by resolution.

NOW, THEREFORE, BE IT RESOLVED BY THE BOARD OF COUNTY COMMISSIONERS OF PALM BEACH COUNTY, FLORIDA, that Zoning Application ABN/CA-2017-01812, the Application of Sunco TH LLC, by WGINC, Agent, for a Class A Conditional Use to allow a Workforce Housing (WFH) density bonus greater than 50 percent, on a parcel of land generally described as shown on the legal description in EXHIBIT A, attached hereto and made a part hereof, and generally located as shown on a vicinity sketch as indicated in EXHIBIT B, attached hereto and made a part hereof, was approved on September 24, 2018, subject to the Conditions of Approval described in EXHIBIT C, attached hereto and made a part hereof.

Commissioner Bernard moved for the approval of the Resolution.

The motion was seconded by Commissioner Abrams and, upon being put to a vote, the vote was as follows:

Commissioner Melissa McKinlay, Mayor	-	Aye
Commissioner Mack Bernard, Vice Mayor	-	Aye
Commissioner Hal R. Valeche	-	Aye
Commissioner Paulette Burdick	-	Aye
Commissioner Dave Kerner	-	Aye
Commissioner Steven L. Abrams	-	Aye
Commissioner Mary Lou Berger	-	Aye

The Mayor thereupon declared that the resolution was duly passed and adopted on September 24, 2018.

Filed with the Clerk of the Board of County Commissioners on October 1st, 2018.

This resolution is effective when filed with the Clerk of the Board of County Commissioners.

APPROVED AS TO FORM
AND LEGAL SUFFICIENCY

PALM BEACH COUNTY, FLORIDA
BY ITS BOARD OF COUNTY
COMMISSIONERS

SHARON R. BOCK,
CLERK & COMPTROLLER

BY:

COUNTY ATTORNEY

BY:

DEPUTY CLERK



EXHIBIT A
LEGAL DESCRIPTION

LEGAL DESCRIPTION:

THE SOUTH 1/2 OF THE EAST 1/3 OF TRACT 1, LESS THE EAST 15 FEET FOR ROAD RIGHT-OF-WAY, AND THE EAST 1/3 OF TRACT 2, LESS THE SOUTH 247.5 FEET THEREOF AND LESS THE EAST 15 FEET FOR THE ROAD RIGHT-OF-WAY, MODEL LAND COMPANY'S SUBDIVISION OF SECTION 14, TOWNSHIP 44 SOUTH, RANGE 42 EAST, ACCORDING TO THE PLAT THEREOF, AS RECORDED IN PLAT BOOK 5, PAGE 78, OF THE PUBLIC RECORDS OF PALM BEACH COUNTY, FLORIDA.

EXHIBIT B
VICINITY SKETCH

LOCATION MAP

N.T.S.

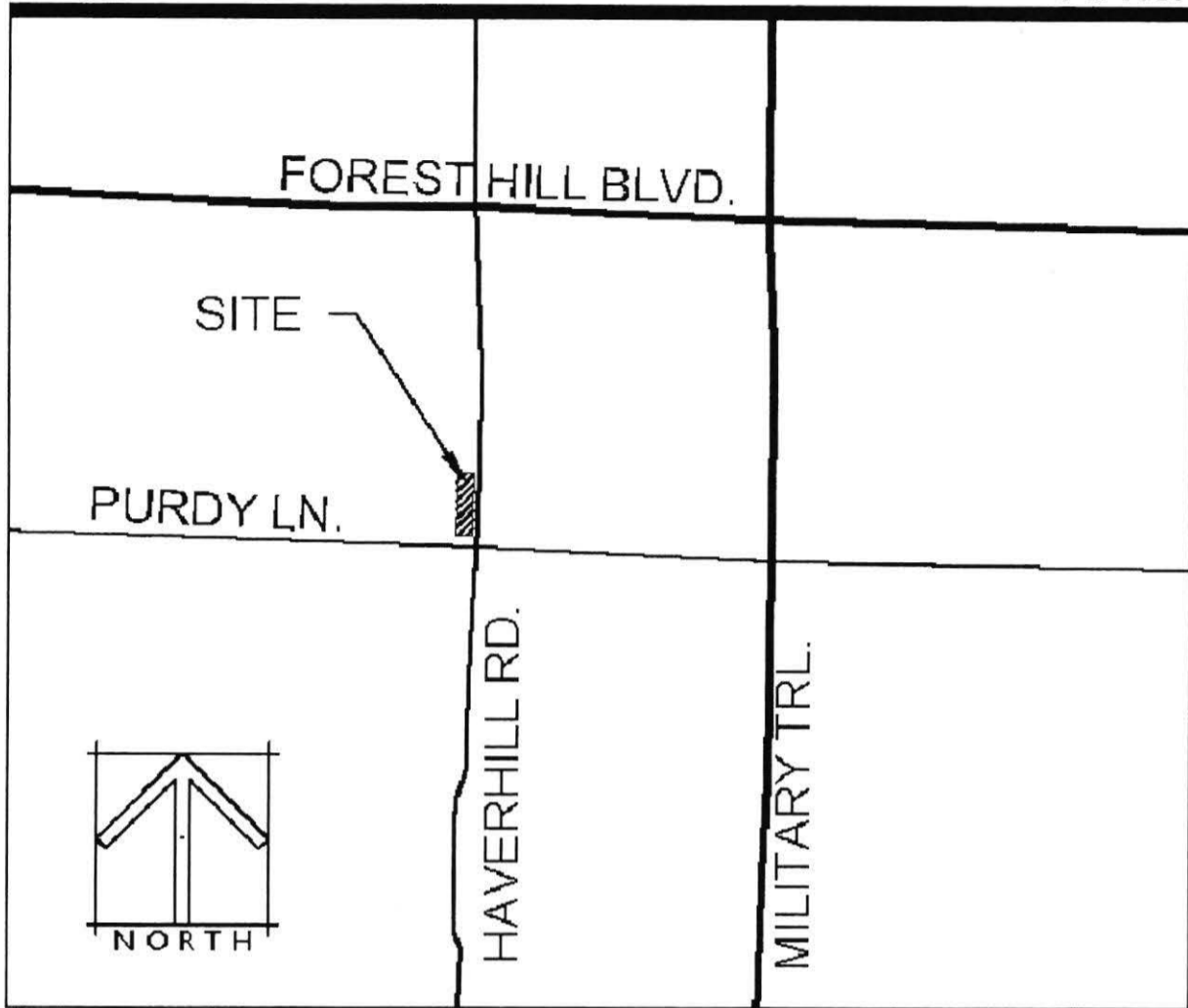

EXHIBIT C

CONDITIONS OF APPROVAL

Conditional Use Class A - Workforce Housing Density Bonus

ALL PETITIONS

1. The approved Site Plan is dated May 29, 2018. Modifications to the Development Order inconsistent with the Conditions of Approval, or changes to the uses or site design beyond the authority of the Development Review Officer as established in the Unified Land Development Code, must be approved by the Board of County Commissioners. (ONGOING: ZONING - Zoning)

ARCHITECTURAL REVIEW

1. At time of submittal for Final Approval by the Development Review Officer (DRO), the Architectural Elevations for the Multifamily Buildings shall be submitted for review and approval by the Zoning Division. Architectural Elevations shall comply with the standards indicated in Article 5.C of the Unified Land Development Code (ULDC). Development shall be consistent with the approved Architectural Elevations, the DRO approved Final Plan, all applicable Conditions of Approval, and all ULDC requirements. (ONGOING: ZONING - Zoning)

ENGINEERING

1. In order to comply with the mandatory Traffic Performance Standards, the Property Owner shall be restricted to the following phasing schedule:

a. No Building Permits for the site may be issued after December 31, 2022. A time extension for this condition may be approved by the County Engineer based upon an approved Traffic Study which complies with Mandatory Traffic Performance Standards in place at the time of the request. This extension request shall be made pursuant to the requirements of Art. 2.E of the Unified Land Development Code. (DATE: MONITORING - Engineering)

2. The Property Owner shall provide to the Palm Beach County Right of Way Section of Roadway Production Division a warranty deed for road right of way and all associated documents as required by the County Engineer for the expanded intersection of Haverhill Road and Purdy Lane on an alignment approved by the County Engineer

All warranty deed(s) and associated documents, including a title policy naming Palm Beach County as an insured, shall be provided and approved prior to the issuance of the first building permit or within ninety (90) days of a request by the County Engineer, whichever shall occur first. Right of way conveyance shall be along the entire frontage and shall be free and clear of all encroachments and encumbrances. Property Owner shall provide Palm Beach County with sufficient documentation acceptable to the Right of Way Section to ensure that the property is free of all encumbrances and encroachments, including a topographic survey. The Property Owner must further warrant that the property being conveyed to Palm Beach County meets all appropriate and applicable environmental agency requirements. In the event of a determination of contamination which requires remediation or clean up on the property now owned by the Property Owner, the Property Owner agrees to hold the County harmless and shall be responsible for all costs of such clean up, including but not limited to, all applicable permit fees, engineering or other expert witness fees including attorney's fees as well as the actual cost of the clean up. Thoroughfare Plan Road right of way conveyances shall be consistent with Palm Beach County's Thoroughfare Right of Way Identification Map and shall include, where appropriate as determined by the County Engineer, additional right of way for Expanded Intersections and Corner Clips. The Property Owner shall not record these required deeds or related documents. The Property Owner shall provide to the Right of Way Section a tax pro-ration. A check, made payable to the Tax Collector's Office, shall be submitted by the Property Owner for the pro-rated taxes. After final acceptance, Palm Beach County shall record all appropriate deeds and documents. (BLDGPMT: MONITORING - Engineering)

3. The Property Owner shall provide an acceptable drainage study identifying any historical drainage from offsite parcels, including proposed grading cross sections. The project's stormwater management system shall be designed to address any historical drainage. The Property Owner shall provide drainage easements, as required, to accommodate offsite drainage.

a. Drainage study shall be provided the Land Development Division prior to final approval of the Site Plan by the DRO. (DRO: ENGINEERING - Engineering)

b. Any required drainage easements shall be recorded prior to issuance of the first building permit. (BLDGPM: ENGINEERING - Engineering)

4. Prior to issuance of the first building permit, the Property Owner shall provide to Palm Beach County sufficient public road drainage easement(s) through the project's internal drainage system, as required by and approved by the County Engineer, to provide legal positive outfall for runoff from those segments of Haverhill Road along the property frontage; and a maximum of an additional 800 feet of these adjacent roadway(s), with an assumed impervious area of 95-percent, unless otherwise approved by the County Engineer. The limits of this additional 800 feet of drainage shall be determined by the County Engineer. Said easements shall be no less than 20 feet in width. Portions of such system not included within roadways or waterways dedicated for drainage purposes will be specifically encumbered by said minimum 20 foot drainage easement from the point of origin, to the point of legal positive outfall. The drainage system within the project shall have sufficient water quality, water quantity and, when necessary, compensating storage capacity within this project's system as required by all permitting agencies, as well as conveyance capacity to meet the storm water discharge and treatment requirements of Palm Beach County, the applicable Drainage District, and the South Florida Water Management District, for the combined runoff from the project to accommodate the ultimate Thoroughfare Plan Road Section(s) of the included segment. Specifically, one through lane must be open during the 25-year, 3-day storm and the elevation for the 3-year, 1-day storm event shall provide sufficient freeboard to allow for efficient roadway drainage system design. If required and approved by the County Engineer, the Property Owner shall construct within the proposed drainage easements a minimum of 24 inch closed piping system and appropriate wingwall or other structures as required by and approved by the County Engineer. Elevation and location of the entire drainage system shall be approved by the County Engineer. Any and all excess fill material from excavation by Palm Beach County within said easements shall become the property of Palm Beach County which at its discretion may use this fill material. The Property Owner shall not record these required easements or related documents. After final acceptance of the location, legal sketches and dedication documents, Palm Beach County shall record all appropriate deeds and documents. (BLDGPM: MONITORING - Engineering)

5. The Property Owner shall restripe the median on Haverhill Rd to provide a south approach left turn lane at the project's main entrance. This turn lane shall be 280 ft in length with 50 ft taper or as approved by the County Engineer. The restriping shall minimally impact the existing north approach left turn lane at the intersection of Purdy Ln and Haverhill Rd.

This construction shall be concurrent with the paving and drainage improvements for the site. Any and all costs associated with the construction shall be paid by the Property Owner. These costs shall include, but are not limited to, utility relocations and acquisition of any additional required right-of-way.

a. Permits required from Palm Beach County for this construction shall be obtained prior to the issuance of the first building permit. (BLDGPM: MONITORING - Engineering)

b. Construction shall be completed prior to the issuance of the first Certificate of Occupancy. (BLDGPM/CO: MONITORING - Engineering)

6. The northern driveway of the property shall be used only for emergency access and shall be gated all the time with no resident access permits. (ONGOING: ENGINEERING - Engineering)

LANDSCAPE - GENERAL-PERIMETER LANDSCAPING ALONG ALL PROPERTY LINES

1. No easement encroachment or width reduction shall be permitted for all perimeter Landscape Buffers, with the exception of a maximum of five (5) foot encroachment for Utility Easements, or five (5) foot for the drainage retention area along the north Property Line. (ONGOING: ZONING - Zoning)

LANDSCAPE - GENERAL-PERIMETER LANDSCAPING ALONG THE WEST PROPERTY LINE (ABUTTING RESIDENTIAL)

1. In addition to Code requirements, landscaping and buffering along the west property line shall be upgraded to include the following:

- a. width of the buffer shall be a minimum of eight (8) feet except areas where the buffer abuts Residential Buildings 1 and 2. Width of the buffer adjacent to the west side of Residential Building 1 shall be expanded to fifteen (15) feet for a minimum length of 200 feet. Width of the buffer adjacent to the west side of Residential Building 2 shall be expanded to fifteen (15) feet for a minimum length of 100 feet;
- b. a continuous opaque wood fence with a minimum height of six (6) feet for the entire length of the west property line. Gate opening shall be provided for the maintenance access of the buffer;
- c. One (1) large palm for each thirty (30) linear feet of the length of the west property line. Palms shall be planted in clusters of three (3) to five (5);
- d. One (1) large shrub for each four (4) lineal feet of the length of the expanded buffer.
- e. Prior to Final Approval by the Development Review Officer, the Site Plan shall be revised to indicate the expanded buffer areas. (DRO/ONGOING: ZONING - Zoning)

LANDSCAPE - GENERAL-PERIMETER LANDSCAPING ALONG THE SOUTH PROPERTY LINE (ABUTTING RESIDENTIAL)

1. In addition to Code requirements, landscaping and buffering along the south property line shall be upgraded to include the following:

- a. width of the buffer shall be a minimum of eight (8) feet;
- b. a continuous opaque wood fence with a minimum height of six (6) feet for the entire length of the west property line. Gate opening shall be provided for the maintenance access of the buffer; and,
- c. One (1) small palm for each thirty (30) linear feet of the length of the west property line. Palms shall be planted in clusters of three (3) to five (5). (DRO/ONGOING: ZONING - Zoning)

LIGHTING

1. In addition to Code Requirements, security lighting shall be installed in all pedestrian breezeways or corridors within each building and on all floors. (BLDGPM/ONGOING: ZONING - Zoning)

PLANNING

1. Prior to the issuance of the first Building Permit, the property owner shall record in the public records of Palm Beach County a Declaration of Restrictive Covenants, in a form acceptable to the Palm Beach County Attorney, which includes but is not limited to the following:

Guarantees the attainability of all required workforce units required per ULDC Article 5.G. These units are to be distributed among the categories (low, moderate 1, moderate 2, and middle) consistent with the requirements in ULDC Article 5.G. The site plan shall also be modified to include the OR Book and Page of the recorded document and provide a copy of the revised site plan to Planning. (BLDGPM/ MONITORING - Planning)

2. On an annual basis, beginning July 1, 2021, or as otherwise stipulated in the Declaration of Restrictive Covenants, the owner of the WHP unit shall submit to the Planning Director, or designee, on a form provided by the County, an annual report containing information and documentation to demonstrate continued compliance with the WHP and a copy of any monitoring information provided to and received from the appropriate funding agency/source. (DATE/ONGOING: MONITORING - Planning)

SCHOOL BOARD

1. The property owner shall post a notice of annual boundary school assignments for students from this development. A sign 11" X 17" shall be posted in a clear and visible location in all sales offices and models with the following:

"NOTICE TO PARENTS OF SCHOOL AGE CHILDREN"

School age children may not be assigned to the public school closest to their residences. School Board policies regarding levels of service or other boundary policy decisions affect school boundaries. Please contact the Palm Beach County School District Boundary Office at (561) 434-8100 for the most current school assignment(s). (ONGOING: SCHOOL BOARD - School Board)

2. Prior to the issuance of the first Certificate of Occupancy (CO), the 10' by 15' school bus shelter shall be constructed by the Property Owner in a location and manner acceptable to the Palm Beach County School Board. Provisions for the bus shelter shall include, at a minimum, a covered area, continuous paved pedestrian and bicycle access from the subject property or use, to the shelter. Maintenance of the bus shelter shall be the responsibility of the residential Property Owner. (CO: MONITORING - School Board)

SITE DESIGN-DUMPSTER

1. Prior to approval by the DRO, the Property owner shall relocated the Dumpster Station to the North side of Building 1 (DRO: ZONING – Zoning)

SITE DESIGN-PEDESTRIAN CONNECTIVITY

1. Prior to approval by the DRO the Site Plan shall be revised to indicate a pedestrian connection from Building 1 to the Recreation facility. (DRO: ZONING - Zoning)

COMPLIANCE

1. In Granting this Approval, the Board of County Commissioners relied upon the oral and written representations of the Property Owner/Applicant both on the record and as part of the application process. Deviations from or violation of these representations shall cause the Approval to be presented to the Board of County Commissioners for review under the Compliance Condition of this Approval. (ONGOING: ZONING - Zoning)

2. Failure to comply with any of the Conditions of Approval for the subject property at any time may result in:

- a. The Issuance of a Stop Work Order; the Issuance of a Cease and Desist Order; the Denial or Revocation of a Building Permit; the Denial or Revocation of a Certificate of Occupancy; the Denial of any other Permit, License or Approval to any developer, owner, lessee, or user of the subject property; the Revocation of any other permit, license or approval from any developer, owner, lessee, or user of the subject property; the Revocation of any concurrency; and/or
- b. The Revocation of the Official Map Amendment, Conditional Use, Requested Use, Development Order Amendment, and/or any other zoning approval; and/or
- c. A requirement of the development to conform with the standards of the Unified Land Development Code at the time of the finding of non-compliance, or the addition or modification of conditions reasonably related to the failure to comply with existing Conditions of Approval; and/or
- d. Referral to Code Enforcement; and/or
- e. Imposition of entitlement density or intensity.

Staff may be directed by the Executive Director of PZ&B or the Code Enforcement Special Master to schedule a Status Report before the body which approved the Official Zoning Map Amendment, Conditional Use, Requested Use, Development Order Amendment, and/or other zoning approval, in accordance with the provisions of Section 2.E of the ULDC, in response to any flagrant violation and/or continued violation of any Condition of Approval. (ONGOING: ZONING - Zoning)

DISCLOSURE

1. All applicable state or federal permits shall be obtained before commencement of the development authorized by this Development Permit.