

RESOLUTION NO. R-2019- 0390

RESOLUTION APPROVING ZONING APPLICATION ZV/PDD/W-2018-00798
(CONTROL NO. 2002-90045)
a Type 2 Waiver
APPLICATION OF Palm Beach West Associates I LLLP
BY G.L. Homes, AGENT
(Indian Trail Groves)

WHEREAS, the Board of County Commissioners, as the governing body of Palm Beach County, Florida, pursuant to the authority vested in Chapter 163 and Chapter 125, Florida Statutes, is authorized and empowered to consider applications relating to zoning;

WHEREAS, the notice and public hearing requirements pursuant to Article 2 (Application Processes and Procedures) of the Palm Beach County Unified Land Development Code (ULDC), Ordinance 2003-067, Supplement 24, have been satisfied;

WHEREAS, Zoning Application ZV/PDD/W-2018-00798 was presented to the Board of County Commissioners at a public hearing conducted on March 25, 2019;

WHEREAS, the Board of County Commissioners has considered the evidence and testimony presented by the Applicant and other interested parties, the recommendations of the various County Review Agencies, and the recommendation of the Zoning Commission;

WHEREAS, the Board of County Commissioners pursuant to Article 2 (Application Processes and Procedures) of the ULDC is authorized and empowered to consider, approve, approve with conditions or deny the request;

WHEREAS, the Board of County Commissioners hereby incorporates by reference the Findings in the staff report addressing the Standards contained in Article 2.B (Public Hearing Processes) for a Type 2 Waiver;

WHEREAS, this approval is subject to Article 2.E (Monitoring), of the ULDC and other provisions requiring that development commence in a timely manner;

WHEREAS, the issuance of this Development Permit does not in any way create any rights on the part of the Applicant and/or Property Owner to obtain a permit from a state or federal agency and does not create any liability on the part of the County for issuance of the permit if the Applicant fails to obtain requisite approvals or fulfill the obligations imposed by a state or federal agency or undertakes actions that result in a violation of state or federal law;

WHEREAS, the Palm Beach County Survey Section may administratively correct any scrivener's errors that will not significantly impact the overall boundary of the adopted legal description; and,

WHEREAS, Article 2.B.6.C (Board Action) of the ULDC requires that the action of the Board of County Commissioners be adopted by resolution.

NOW, THEREFORE, BE IT RESOLVED BY THE BOARD OF COUNTY COMMISSIONERS OF PALM BEACH COUNTY, FLORIDA, that Zoning Application ZV/PDD/W-2018-00798, the Application of Palm Beach West Associates I LLLP, by G.L. Homes, Agent, for a Type 2 Waiver to allow more than 40 percent of local streets to terminate in a cul-de-sac or dead end, on a parcel of land generally described as shown on the legal description in EXHIBIT A, attached hereto and made a part hereof, and generally located as shown on a vicinity sketch as indicated in EXHIBIT B, attached hereto and made a part hereof, was approved on March 25, 2019, subject to the Conditions of Approval described in EXHIBIT C, attached hereto and made a part hereof.

Commissioner McKinlay moved for the approval of the Resolution.

The motion was seconded by Commissioner Kerner and, upon being put to a vote, the vote was as follows:

Commissioner Mack Bernard, Mayor	- Aye
Commissioner Dave Kerner, Vice Mayor	- Aye
Commissioner Hal R. Valeche	- Aye
Commissioner Gregg K. Weiss	- Aye
Commissioner Robert S. Weinroth	- Aye
Commissioner Mary Lou Berger	- Aye
Commissioner Melissa McKinlay	- Aye

The Mayor thereupon declared that the resolution was duly passed and adopted on March 25, 2019.

Filed with the Clerk of the Board of County Commissioners on April 4th, 2019.

This resolution is effective when filed with the Clerk of the Board of County Commissioners.

APPROVED AS TO FORM
AND LEGAL SUFFICIENCY

PALM BEACH COUNTY, FLORIDA
BY ITS BOARD OF COUNTY
COMMISSIONERS

SHARON R. BOCK,
CLERK & COMPTROLLER

BY:

COUNTY ATTORNEY

BY:



DEPUTY CLERK FLORIDA



EXHIBIT A

LEGAL DESCRIPTION

PARCEL 1:

A PARCEL OF LAND LYING IN SECTIONS 19, 20, 21, 22, 27, 30, 31, THE SOUTH HALF OF SECTIONS 17 AND 18, AND THE NORTH HALF OF SECTION 34, TOWNSHIP 42 SOUTH, RANGE 40 EAST, AND SECTIONS 25 AND 26, TOWNSHIP 42 SOUTH, RANGE 39 EAST, PALM BEACH COUNTY, FLORIDA, BEING MORE PARTICULARLY DESCRIBED AS FOLLOWS:

BEING ALL OF SECTIONS 19, 20, 21, 22, 27 AND 30; TOGETHER WITH THE SOUTH ONE-HALF (S 1/2) OF SECTIONS 17 AND 18; ALL THAT PART OF SECTION 31 LYING NORTH AND EAST OF THE 660 FOOT FLORIDA POWER & LIGHT COMPANY RIGHT OF WAY AS RECORDED IN OFFICIAL RECORDS BOOK 2431, AT PAGE 1704 OF THE PUBLIC RECORDS OF PALM BEACH COUNTY, FLORIDA; AND THE NORTH ONE-HALF (N 1/2) OF SECTION 34, ALL IN TOWNSHIP 42 SOUTH, RANGE 40 EAST, PALM BEACH COUNTY, FLORIDA.

LESS AND NOT INCLUDING THE FOLLOWING DESCRIBED PARCEL, AS RECORDED IN OFFICIAL RECORDS BOOK 4004, AT PAGE 136 OF THE PUBLIC RECORDS OF PALM BEACH COUNTY, FLORIDA:

THE NORTH 135 FEET OF THE SOUTH 1/2 OF SECTIONS 17 AND 18, TOWNSHIP 42 SOUTH, RANGE 40 EAST, PALM BEACH COUNTY, FLORIDA.

ALSO LESS AND NOT INCLUDING THE FOLLOWING DESCRIBED PARCEL, AS RECORDED IN OFFICIAL RECORDS BOOK 9363, AT PAGE 813 OF THE PUBLIC RECORDS OF PALM BEACH COUNTY, FLORIDA:

PARK

THE PARCELS OF LAND LYING IN THE NORTH HALF (N 1/2) OF THE NORTH HALF (N 1/2) OF SECTION 22, TOWNSHIP 42 SOUTH, RANGE 40 EAST, PALM BEACH COUNTY, FLORIDA, BEING MORE PARTICULARLY DESCRIBED AS FOLLOWS:

THE NORTHWEST QUARTER OF THE NORTHEAST QUARTER OF SAID SECTION 22, LESS THE EAST 425 FEET THEREOF; ALSO LESS THE NORTH 50 FEET THEREOF;

TOGETHER WITH

THE NORTHEAST QUARTER OF THE NORTHWEST QUARTER OF SAID SECTION 22, LESS THE WEST 195 FEET THEREOF; ALSO LESS THE NORTH 50 FEET THEREOF.

ALSO LESS AND NOT INCLUDING THE FOLLOWING DESCRIBED PARCEL:

SCHOOL SITE (OFFICIAL RECORDS BOOK 11559, PAGE 1999)

THE EAST 978.88 FEET OF THE SOUTH 1335.00 FEET OF THE NORTHEAST ONE-QUARTER (NE 1/4) OF SECTION 34, TOWNSHIP 42 SOUTH, RANGE 40 EAST, PALM BEACH COUNTY, FLORIDA.

ALSO LESS AND NOT INCLUDING THE FOLLOWING PARCEL:

MIDDLE SCHOOL SITE (OFFICIAL RECORDS BOOK 13335, PAGE 1490)

A PARCEL OF LAND LYING IN THE NORTHEAST ONE-QUARTER (NE 1/4) OF SECTION 34, TOWNSHIP 42 SOUTH, RANGE 40 EAST, PALM BEACH COUNTY, FLORIDA, BEING FURTHER DESCRIBED AS FOLLOWS:

COMMENCE AT THE SOUTHEAST CORNER OF SAID NORTHEAST ONE-QUARTER (1/4); THENCE NORTH 00° 05' 37" WEST, ALONG THE EAST LINE OF SAID SECTION 34, A DISTANCE OF 1335.00 FEET TO THE POINT OF BEGINNING; THENCE DEPARTING SAID EAST SECTION LINE, NORTH 89° 58' 53" WEST, A DISTANCE OF 1372.00 FEET; THENCE NORTH 00° 05' 37" WEST, A DISTANCE OF 901.00 FEET; THENCE NORTH 89° 26' 02" EAST, A DISTANCE OF 1372.04 FEET TO THE EAST LINE OF SAID SECTION 34; THENCE SOUTH 00° 05' 37" EAST, A DISTANCE OF 915.00 FEET TO THE POINT OF BEGINNING.

BEARINGS ARE BASED ON THE SOUTH LINE OF THE NORTHEAST ONE-QUARTER (NE 1/4) OF SECTION 34, TOWNSHIP 42 SOUTH, RANGE 40 EAST, PALM BEACH COUNTY, FLORIDA, BEING NORTH 89° 58' 53" WEST.

AND LESS AND NOT INCLUDING THE FOLLOWING PARCEL:

HIGH SCHOOL SITE (OFFICIAL RECORDS BOOK 14689, PAGE 1639)

A PARCEL OF LAND LYING IN THE NORTHEAST ONE-QUARTER (1/4) OF SECTION 22, TOWNSHIP 42 SOUTH, RANGE 40 EAST, PALM BEACH COUNTY, FLORIDA, BEING MORE PARTICULARLY DESCRIBED AS FOLLOWS:

BEGINNING AT THE NORTHEAST CORNER OF SAID SECTION 22; THENCE SOUTH 00° 02' 47" WEST ALONG THE EAST LINE OF SAID NORTHEAST QUARTER (NE 1/4), A DISTANCE OF 1481.20 FEET; THENCE NORTH 89° 53' 55" WEST, A DISTANCE OF 1763.98 FEET; THENCE NORTH 00° 00' 18" EAST, A DISTANCE OF 1481.20 FEET TO A POINT ON THE NORTH LINE OF SAID NORTHEAST QUARTER (NE 1/4); THENCE SOUTH 89° 53' 55" EAST, A DISTANCE OF 1765.05 FEET TO THE POINT OF BEGINNING.

ALSO LESS AND NOT INCLUDING THE FOLLOWING DESCRIBED PARCEL:

PALM BEACH COUNTY PARCEL

THE PARCELS OF LAND LYING IN THE NORTH HALF (N 1/2) OF THE NORTH HALF (N 1/2) OF SECTION 22, TOWNSHIP 42 SOUTH, RANGE 40 EAST, PALM BEACH COUNTY, FLORIDA, MORE PARTICULARLY DESCRIBED AS FOLLOWS:

THE NORTH 50.00 FEET OF THE NORTHWEST 1/4 OF THE NORTHEAST 1/4 OF SAID SECTION 22, LESS THE EAST 425.00 FEET THEREOF.

TOGETHER WITH

THE NORTH 50.00 FEET OF THE NORTHEAST 1/4 OF THE NORTHWEST 1/4 OF SAID SECTION 22, LESS THE WEST 195.00 FEET THEREOF.

PARCEL 2:

SECTION 4, TOWNSHIP 43 SOUTH, RANGE 40 EAST; AND ALL THAT PART OF SECTION 3, TOWNSHIP 43 SOUTH, RANGE 40 EAST, LYING NORTH OF THE FOLLOWING DESCRIBED LINE: BEGINNING AT A POINT ON THE WEST LINE OF SAID SECTION 3, SAID POINT BEING 2,632.90 FEET SOUTH OF THE NORTHWEST CORNER OF SAID SECTION; THENCE RUNNING IN A NORTHEASTERLY DIRECTION A DISTANCE OF 3,610.56 FEET, MORE OR LESS, TO A POINT ON THE NORTH LINE OF SAID SECTION, 2,530.47 FEET EAST OF THE NORTHWEST CORNER THEREOF.

EXCEPTING THEREFROM THAT PORTION OF SAID SECTION 4 CONVEYED TO THE CITY OF WEST PALM BEACH AS DESCRIBED IN THE DEED FROM INDIAN TRAIL RANCH, INC., DATED JULY 26, 1956 AND RECORDED SEPTEMBER 25, 1956 IN DEED BOOK 1156, PAGE 58, WHICH DEED WAS CORRECTED IN PART BY THE CORRECTIVE QUIT CLAIM DEED DATED OCTOBER 7, 1963 AND FILED OCTOBER 8, 1963 IN OFFICIAL RECORDS BOOK 924, PAGE 965.

ALSO EXCEPTING THEREFROM THE NORTH 100 FEET OF SECTION 4 AND THE NORTH 100 FEET OF THAT PORTION OF SECTION 3 LYING WEST OF THE RIGHT OF WAY LINE OF THE M CANAL, ALL IN TOWNSHIP 43 SOUTH, RANGE 40 EAST, PALM BEACH COUNTY.

CONTAINING A TOTAL OF 4,871.569 ACRES MORE OR LESS.

EXHIBIT B
VICINITY SKETCH

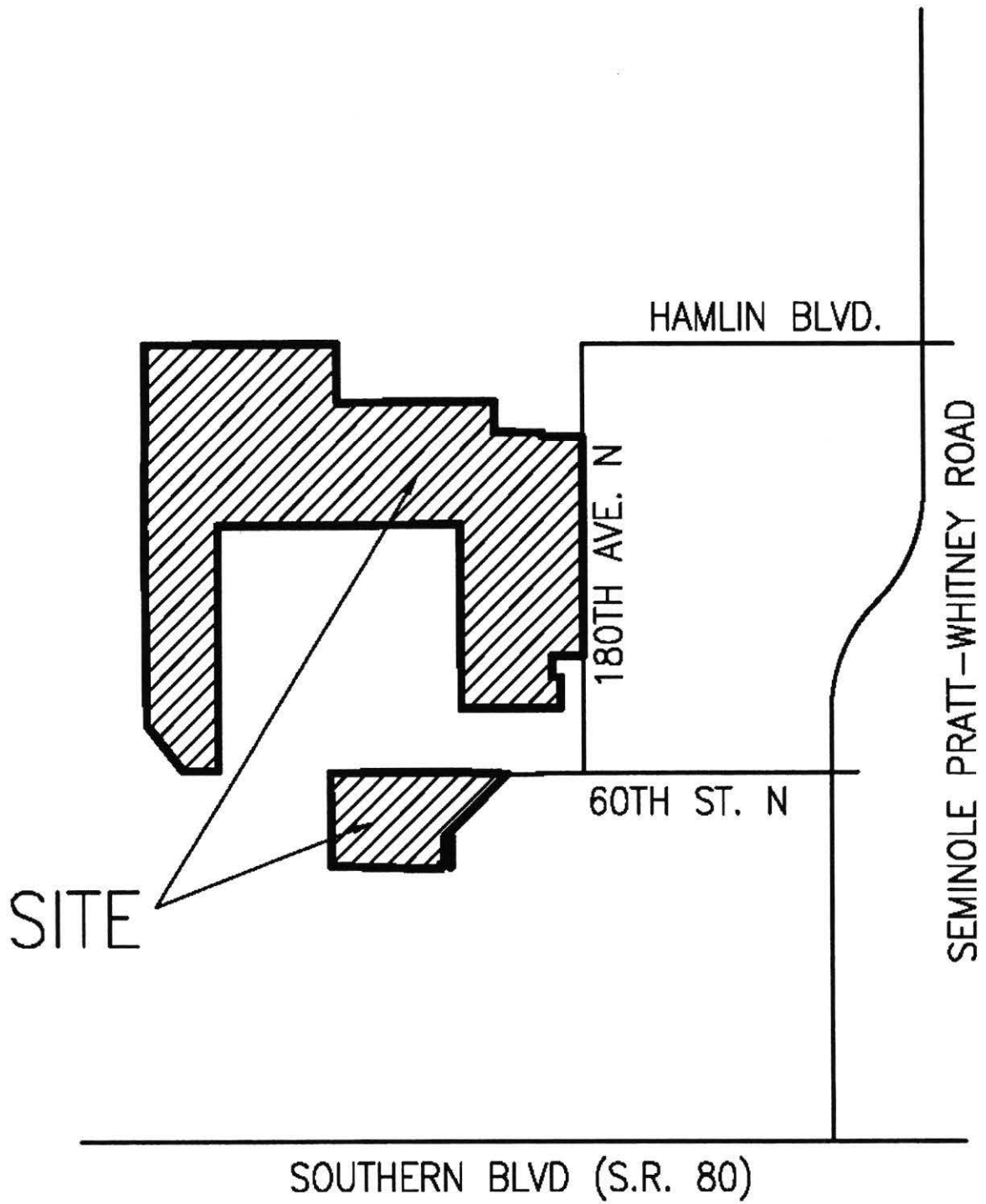

EXHIBIT C

CONDITIONS OF APPROVAL

Type 2 Waiver

ALL PETITIONS

1. This Waiver is approved based on the layout as shown on the Preliminary Master Plan dated August 13, 2018. Only minor modifications by Board of County Commissioners (BCC) or Development Review Officer (DRO) shall be permitted provided the changes are consistent with this Plan. (ONGOING: ZONING - Zoning)

COMPLIANCE

1. In Granting this Approval, the Board of County Commissioners relied upon the oral and written representations of the Property Owner/Applicant both on the record and as part of the application process. Deviations from or violation of these representations shall cause the Approval to be presented to the Board of County Commissioners for review under the Compliance Condition of this Approval. (ONGOING: MONITORING - Zoning)

2. Failure to comply with any of the Voluntary Commitments of Approval for the subject property at any time may result in:

a. The Issuance of a Stop Work Order; the Issuance of a Cease and Desist Order; the Denial or Revocation of a Building Permit; the Denial or Revocation of a Certificate of Occupancy; the Denial of any other Permit, License or Approval to any developer, owner, lessee, or user of the subject property; the Revocation of any other permit, license or approval from any developer, owner, lessee, or user of the subject property; the Revocation of any concurrency; and/or,

b. The Revocation of the Official Map Amendment, Conditional Use, Requested Use, Development Order Amendment, and/or any other zoning approval; and/or,

c. A requirement of the development to conform with the standards of the Unified Land Development Code at the time of the finding of non-compliance, or the addition or modification of conditions reasonably related to the failure to comply with existing Voluntary Commitments; and/or,

d. Referral to Code Enforcement; and/or,

e. Imposition of entitlement density or intensity.

Staff may be directed by the Executive Director of PZ&B or the Code Enforcement Special Master to schedule a Status Report before the body which approved the Official Zoning Map Amendment, Conditional Use, Requested Use, Development Order Amendment, and/or other Zoning Approval, in accordance with the provisions of Section 2.E of the ULDC, in response to any flagrant violation and/or continued violation of any Voluntary Commitment of Approval. (ONGOING: MONITORING - Zoning)

DISCLOSURE

1. All applicable state or federal permits shall be obtained before commencement of the development authorized by this Development Permit.