

RESOLUTION NO. R-2024- 1031

RESOLUTION APPROVING ZONING APPLICATION PDD/CA-2022-01922
(CONTROL NO. 2022-00112)
a Class A Conditional Use
APPLICATION OF Carl Jobson, Job-Man Development, LLC - Daniel Mancini
BY Schmidt Nichols, AGENT
(Boynton Place MUPD)

WHEREAS, the Board of County Commissioners, as the governing body of Palm Beach County, Florida, pursuant to the authority vested in Chapter 163 and Chapter 125, Florida Statutes, is authorized and empowered to consider applications relating to zoning;

WHEREAS, the notice and public hearing requirements pursuant to Article 2 (Application Processes and Procedures) of the Palm Beach County Unified Land Development Code, Ordinance 2003-067 as amended (ULDC), have been satisfied;

WHEREAS, Zoning Application PDD/CA-2022-01922 was presented to the Board of County Commissioners at a public hearing conducted on August 22, 2024;

WHEREAS, the Board of County Commissioners has considered the evidence and testimony presented by the Applicant and other interested parties, the recommendations of the various County Review Agencies, and the recommendation of the Zoning Commission;

WHEREAS, the Board of County Commissioners pursuant to Article 2 (Application Processes and Procedures) of the ULDC is authorized and empowered to consider, approve, approve with conditions or deny the request;

WHEREAS, the Board of County Commissioners hereby incorporates by reference the Findings in the staff report addressing the Standards contained in Article 2.B (Public Hearing Processes) for a Class A Conditional Use;

WHEREAS, this approval is subject to Article 2.E (Monitoring), of the ULDC and other provisions requiring that development commence in a timely manner;

WHEREAS, the issuance of this Development Permit does not in any way create any rights on the part of the Applicant and/or Property Owner to obtain a permit from a state or federal agency and does not create any liability on the part of the County for issuance of the permit if the Applicant fails to obtain requisite approvals or fulfill the obligations imposed by a state or federal agency or undertakes actions that result in a violation of state or federal law;

WHEREAS, the Palm Beach County Survey Section may administratively correct any scrivener's errors that will not significantly impact the overall boundary of the adopted legal description; and,

WHEREAS, Article 2.B.6.C (Board Action) of the ULDC requires that the action of the Board of County Commissioners be adopted by resolution.

NOW, THEREFORE, BE IT RESOLVED BY THE BOARD OF COUNTY COMMISSIONERS OF PALM BEACH COUNTY, FLORIDA, that:

1. The foregoing recitals are true and correct and are incorporated herein.
2. Zoning Application PDD/CA-2022-01922, the Application of Carl Jobson, Job-Man Development, LLC - Daniel Mancini, by Schmidt Nichols, Agent, for a Class A Conditional Use to allow Light Vehicle Sales and Rental on 8.86 acres, on a parcel of land generally described as shown on the legal description in EXHIBIT A, attached hereto and made a part hereof, and generally located as shown on a vicinity sketch as indicated in EXHIBIT B, attached hereto and made a part hereof, was approved on August 22, 2024, subject to the Conditions of Approval described in EXHIBIT C, attached hereto and made a part hereof.

Commissioner Baxter moved for the approval of the Resolution.

The motion was seconded by Commissioner Marino and, upon being put to a vote, the vote was as follows:

Commissioner Maria Sachs, Mayor	-	Aye
Commissioner Maria G. Marino, Vice Mayor	-	Aye
Commissioner Gregg K. Weiss	-	Aye
Commissioner Michael A. Barnett	-	Aye
Commissioner Marci Woodward	-	Absent
Commissioner Sara Baxter	-	Aye
Commissioner Mack Bernard	-	Aye

The Mayor thereupon declared that the resolution was duly passed and adopted on August 22, 2024.

Filed with the Clerk of the Board of County Commissioners on August 26, 2024

This resolution shall not become effective unless or until the effective date of the Small Scale Land Use Amendment SCA-2023-00020.

APPROVED AS TO FORM
AND LEGAL SUFFICIENCY

PALM BEACH COUNTY, FLORIDA
BY ITS BOARD OF COUNTY
COMMISSIONERS

BY: 
COUNTY ATTORNEY

JOSEPH ABRUZZO,
CLERK & COMPTROLLER
BY: 
DEPUTY CLERK



EXHIBIT A

LEGAL DESCRIPTION

A PARCEL OF LAND SITUATE IN SECTION 22, TOWNSHIP 45 SOUTH, RANGE 42 EAST PALM BEACH COUNTY, FLORIDA, BEING MORE PARTICULARLY DESCRIBED AS FOLLOWS:

COMMENCING AT THE SOUTHWEST CORNER OF THE SOUTHEAST ONE-QUARTER (SEC 1/4) OF THE AFORESAID SECTION 22; THENCE NORTH $00^{\circ}41'06''$ WEST ALONG THE WEST LINE OF SAID SOUTHEAST ONE-QUARTER (SF 1/4), A DISTANCE OF 1331.34 FEET TO THE SOUTH LINE OF THE NORTHWEST ONE-QUARTER (NW 1/4) OF SAID SOUTHEAST ONE-QUARTER (SE 1/4); THENCE NORTH $89^{\circ}31'42''$ EAST ALONG SAID LINE, A DISTANCE OF 51.88 FEET TO THE EAST RIGHT-OF-WAY LINE OF JOG ROAD, AS DESCRIBED IN OFFICIAL RECORDS BOOK 4224, PAGE 780; THENCE CONTINUE NORTH $89^{\circ}31'42''$ SECONDS EAST, A DISTANCE OF 615.46 FEET TO A POINT ON THE WEST LINE OF THE WEST ONE-HALF (W 1/2) OF THE NORTHEAST ONE-QUARTER (NE 1/4) OF THE SOUTHWEST ONE-QUARTER (SW 1/4) OF THE SOUTHEAST ONE-QUARTER (SE 1/4) OF SAID SECTION 22 AND THE POINT OF BEGINNING; THENCE CONTINUE NORTH $89^{\circ}31'42''$ EAST, A DISTANCE OF 333.67 FEET TO A POINT ON THE EAST LINE OF THE WEST ONE-HALF (W1/2) OF THE EAST ONE-HALF (E 1/2) OF THE SOUTHWEST ONE-QUARTER (SW 1/4) OF THE SOUTHEAST ONE-QUARTER (SE 1/4) OF SAID SECTION 22; THENCE SOUTH $00^{\circ}30'38''$ EAST ALONG SAID LINE, A DISTANCE OF 1168.61 FEET TO A POINT ON THE NORTH RIGHT-OF-WAY LINE OF BOYNTON BEACH BOULEVARD (STATE ROAD 804) AS SHOWN IN COUNTY ROAD PLAT BOOK 2, PAGE 5, AND AS CONVEYED TO THE STATE OF FLORIDA IN OFFICIAL RECORDS BOOK 4251, PAGE 575 AND AS SHOWN ON FLORIDA DEPARTMENT OF TRANSPORTATION RIGHT-OF-WAY MAP SECTION 97931-2347; THENCE NORTH $86^{\circ}24'21''$ WEST ALONG THE SAID NORTH RIGHT-OF-WAY LINE, A DISTANCE OF 333.36 FEET TO A POINT ON THE EAST LINE OF THE EAST ONE-HALF (E1/2) OF THE SOUTHWEST ONE-QUARTER (SE 1/4) OF SAID SECTION 22; THENCE NORTH $00^{\circ}30'38''$ WEST ALONG SAID LINE, A DISTANCE OF 1144.98 FEET TO THE POINT OF BEGINNING, SAID LANDS LYING AND BEING IN PALM BEACH COUNTY, FLORIDA.

ALSO DESCRIBED AS:

A PARCEL OF LAND SITUATE IN SECTION 22, TOWNSHIP 45 SOUTH, RANGE 42 EAST, PALM BEACH COUNTY, FLORIDA, DESCRIBED AS FOLLOWS:

COMMENCING AT THE SOUTHWEST CORNER OF THE SOUTHEAST ONE-QUARTER (SE 1/4) OF SAID SECTION 22; THENCE NORTH $00^{\circ}41'13''$ WEST, ALONG THE WEST LINE OF SAID SOUTHEAST ONE-QUARTER (SE 1/4), 1333.46 FEET TO THE SOUTH LINE OF THE NORTHWEST ONE-QUARTER (NW 1/4) OF THE SOUTHEAST ONE-QUARTER (SE 1/4) OF SAID SECTION 22; THENCE NORTH $89^{\circ}34'27''$ EAST, ALONG SAID SOUTH LINE OF THE NORTHWEST ONE-QUARTER 616.20' TO THE NORTHEAST CORNER OF "FOUNTAINS EAST MUPD", ACCORDING TO THE PLAT THEREOF, AS RECORDED IN PLAT BOOK 130, PAGE 93, OF THE PUBLIC RECORDS OF PALM BEACH COUNTY; THENCE CONTINUE, NORTH $89^{\circ}34'27''$ EAST, ALONG SAID SOUTH LINE OF THE NORTHWEST ONE-QUARTER, 334.10 FEET TO A POINT ON THE WEST LINE OF "BRIARRIDGE PLAT ONE", ACCORDING THE PLAT THEREOF, AS RECORDED IN PLAT BOOK 52, PAGE 57, SAID PUBLIC RECORDS AND THE EAST LINE OF THE WEST ONE-HALF (W 1/2) OF THE EAST ONE-HALF (E 1/2) OF THE SOUTHWEST ONE-QUARTER (SW 1/4) OF THE SOUTHEAST ONE-QUARTER (SE 1/4) OF SAID SECTION 22; THENCE SOUTH $00^{\circ}27'36''$ EAST, ALONG SAID EAST LINE OF SAID WEST ONE-HALF (W 1/2) AND SAID WEST LINE OF "BRIARRIDGE PLAT ONE", A DISTANCE OF 1169.95 FEET TO THE NORTH RIGHT-OF-WAY LINE OF STATE ROAD 804, "BOYNTON BEACH BOULEVARD", ACCORDING TO FLORIDA DEPARTMENT OF TRANSPORTATION RIGHT-OF-WAY MAP SECTION No.: 97931-2347 AND OFFICIAL RECORDS BOOK 4215, PAGE 575, OF SAID PUBLIC RECORDS; THENCE NORTH $86^{\circ}24'21''$ WEST, ALONG SAID NORTH RIGHT-OF-WAY LINE, 333.43 FEET TO THE SOUTHEAST CORNER OF SAID "FOUNTAINS EAST MUPD" AND A POINT ON THE WEST LINE OF THE WEST ONE-HALF (W 1/2) OF THE NORTHEAST ONE-QUARTER (NE 1/4) OF THE SOUTHWEST ONE-QUARTER (SW 1/4) OF THE SOUTHEAST ONE-QUARTER (SE 1/4) OF SAID SECTION 22; THENCE NORTH $00^{\circ}32'07''$ WEST, ALONG SAID EAST LINE OF SAID "FOUNTAINS EAST MUPD" AND SAID WEST LINE OF THE WEST ONE-HALF (W 1/2) OF THE NORTHEAST ONE-QUARTER (NE 1/4) OF THE SOUTHWEST ONE-QUARTER (SW 1/4) OF

THE SOUTHEAST ONE-QUARTER (SE 1/4) OF SAID SECTION 22, A DISTANCE OF 1146.58 FEET, TO SAID NORTHEAST CORNER OF SAID "FOUNTAINS EAST MUPD" AND THE POINT OF BEGINNING.

SAID LANDS LYING AND SITUATE IN PALM BEACH COUNTY FLORIDA, AND CONTAINING 386, 096 SQUARE FEET, (8.8635 ACRES) MORE OR LESS.

EXHIBIT B
VICINITY SKETCH

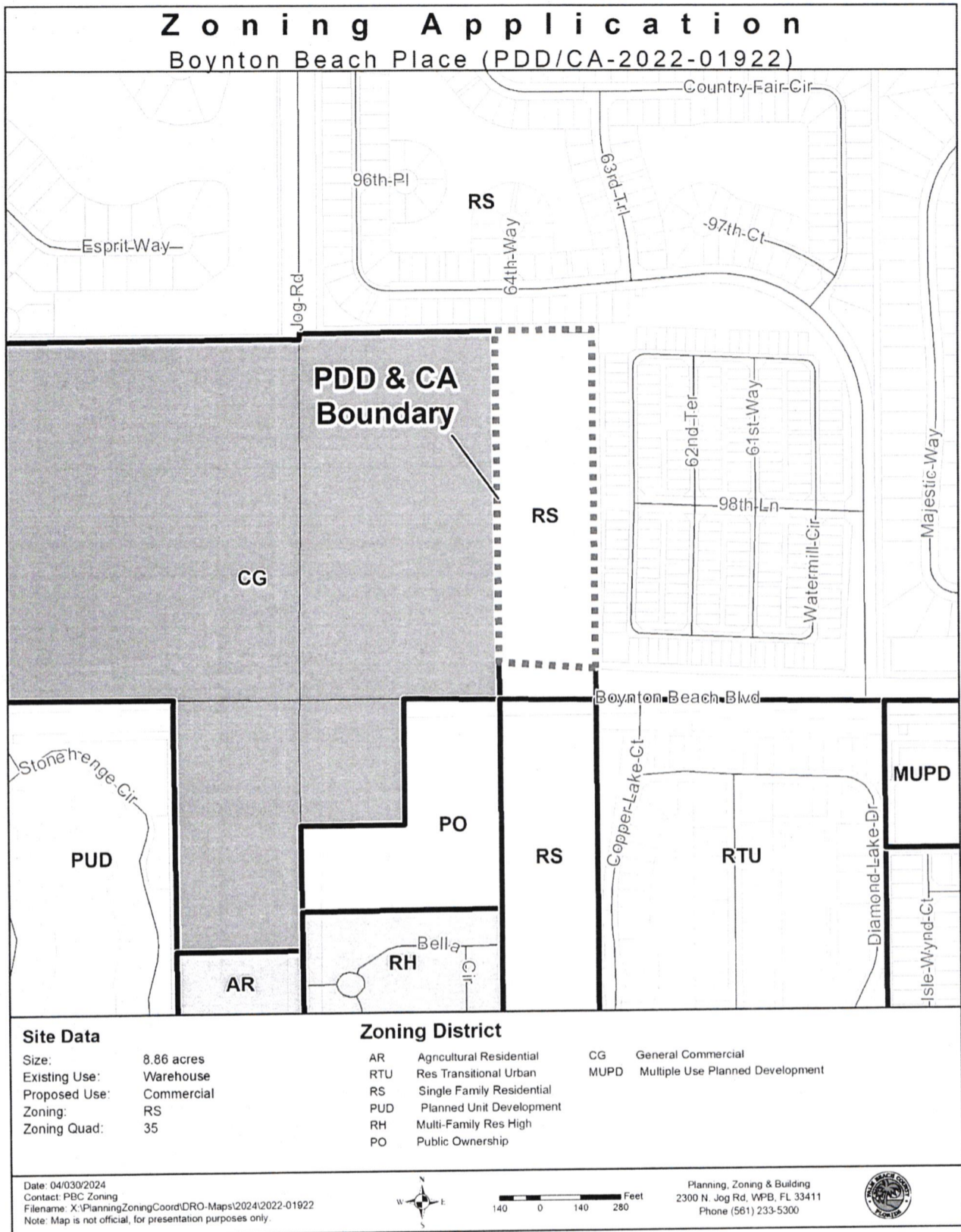

EXHIBIT C

CONDITIONS OF APPROVAL

Class A Conditional Use – Light Vehicle Sales and Rental (Building C)

ALL PETITIONS

1. The approved Preliminary Site Plan is dated June 13, 2024. Modifications to the Development Order inconsistent with the Conditions of Approval, or changes to the uses or site design beyond the authority of the Development Review Officer as established in the Unified Land Development Code, must be approved by the Board of County Commissioners. (ONGOING: ZONING - Zoning)

SIGNS

1. Wall signage shall be prohibited on the east facade of Building C. (ONGOING: ZONING - Zoning)

COMPLIANCE

1. In Granting this Approval, the Board of County Commissioners relied upon the oral and written representations of the Property Owner/Applicant both on the record and as part of the application process. Deviations from or violation of these representations shall cause the Approval to be presented to the Board of County Commissioners for review under the Compliance Condition of this Approval. (ONGOING: MONITORING - Zoning)

2. Failure to comply with any of the Conditions of Approval for the subject property at any time may result in:

- a. The Issuance of a Stop Work Order; the Issuance of a Cease and Desist Order; the Denial or Revocation of a Building Permit; the Denial or Revocation of a Certificate of Occupancy; the Denial of any other Permit, License or Approval to any developer, owner, lessee, or user of the subject property; the Revocation of any other permit, license or approval from any developer, owner, lessee, or user of the subject property; the Revocation of any concurrency; and/or
- b. The Revocation of the Official Map Amendment, Conditional Use, Requested Use, Development Order Amendment, and/or any other zoning approval; and/or
- c. A requirement of the development to conform with the standards of the Unified Land Development Code at the time of the finding of non-compliance, or the addition or modification of conditions reasonably related to the failure to comply with existing Conditions of Approval; and/or
- d. Referral to Code Enforcement; and/or
- e. Imposition of entitlement density or intensity.

Staff may be directed by the Executive Director of PZ&B or the Code Enforcement Special Master to schedule a Status Report before the body which approved the Official Zoning Map Amendment, Conditional Use, Requested Use, Development Order Amendment, and/or other zoning approval, in accordance with the provisions of Section 2.E of the ULDC, in response to any flagrant violation and/or continued violation of any Condition of Approval. (ONGOING: MONITORING - Zoning)

DISCLOSURE

1. All applicable state or federal permits shall be obtained before commencement of the development authorized by this Development Permit.